

Step-In Denim Harness TUTORIAL



1 - MATERIAL

- 1 - Fabric: Any Denim fabric (stretch or regular) or old denim pants.
- 2 - Cotton Bias binding Tape 0.4" folded or 0.8" open (1 cm folded or 2 cm open).
67" (170 cm) long for XXS size - 78" (200 cm) long for Medium Size -
85" (216 cm) for Large Size - 99" (250 cm) for XXL size -
- 3 - Two half-moon Metal (D) Rings, from inside 0.8" (2 cm) for sizes XXS to M,
or 1" (2.5 cm) for sizes L to XXL.
- 4 - One plastic Side Release Buckles Dual, from inside 0.8" (2 cm) for sizes XXS to M,
or 1" (2.5 cm) for sizes L to XXL.
- 5 - (2 cm) Embroidered Flower Lace, or any decorative items.



4 - Assembling

- 1 - Start by inserting the Metal Rings between (B & D) folding lines.
- 2 - Fold it on line (C) and Pin it.
- 3 - Insert the plastic Buckles to the line (A).
- 4 - Fold it on line (A) and insert the extra fabric between (B & D) to hide it.
- 5 - Try it on your dog to calibrate the size by changing the position of lines (B & D) or the position of line (A).
- 6 - Cut the extra fabric inserted between (B & D).

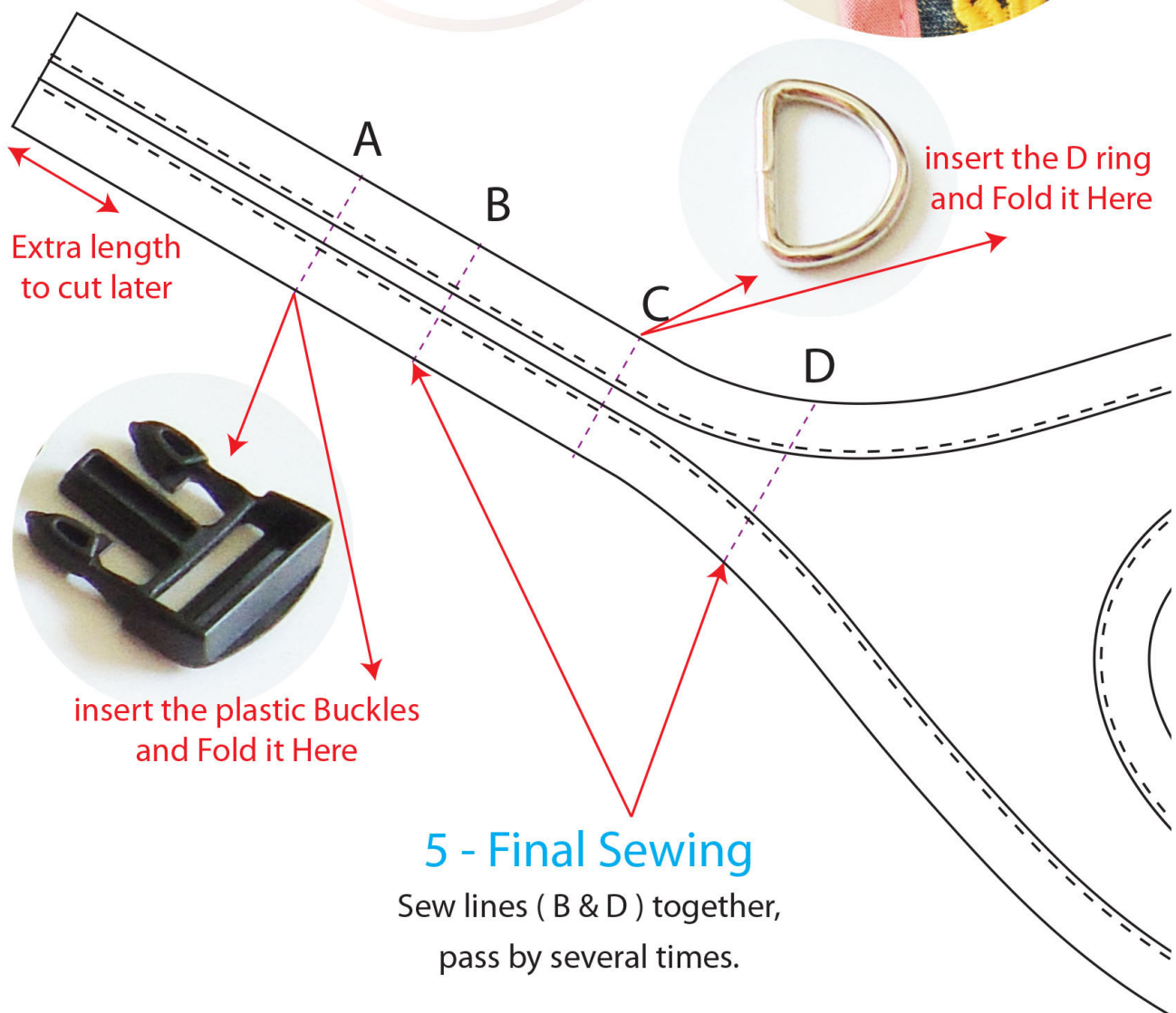

5 - Final Sewing

Sew lines (B & D) together,
pass by several times.

Enjoy your new dog harness